

PROPERTY | WITH PURPOSE

R44,990 per month excl. VAT

R110 per m²



www.spire.co.za

TO LET



409m² Warehouse To Let In Stikland Welcome to River's Edge Business Park! River's Edge Business Park is a new industrial development in Stikland. The park is well located, facing the R300. It is accessed via La Belle Road and connects very easily to both the N1 to the North and N2 to the South. The development consists of 15 units of varying sizes, ranging from 326m² - 761m². Each unit includes an open plan warehouse floor and dedicated office space on both the ground and first floors. Each unit is equipped with 1 roller shutter door measuring 5m tall and 3.5m wide, as well as 1 loading bay per unit. In addition, each unit benefits from open parking directly in front of the unit. 74 parking bays in total are provided. The development...

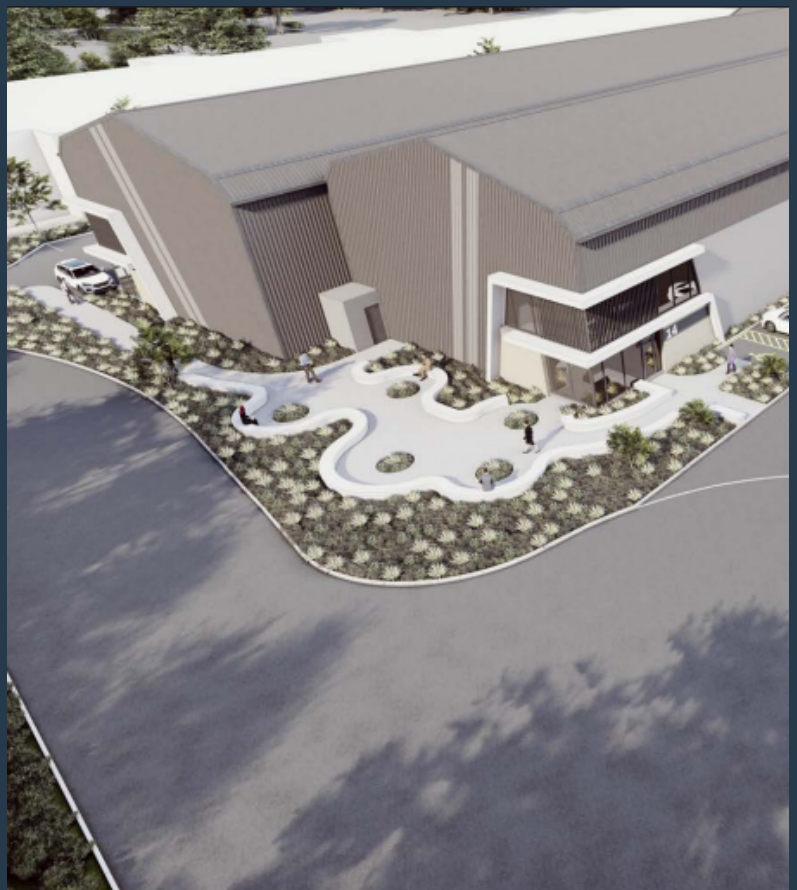

WEB REF: SCL2314

Jack Taggart | 0673061828 | jackt@spire.co.za

PROPERTY | WITH PURPOSE

R44,990 per month excl. VAT

R110 per m²



www.spire.co.za

409M² WAREHOUSE TO LET IN STIKLAND

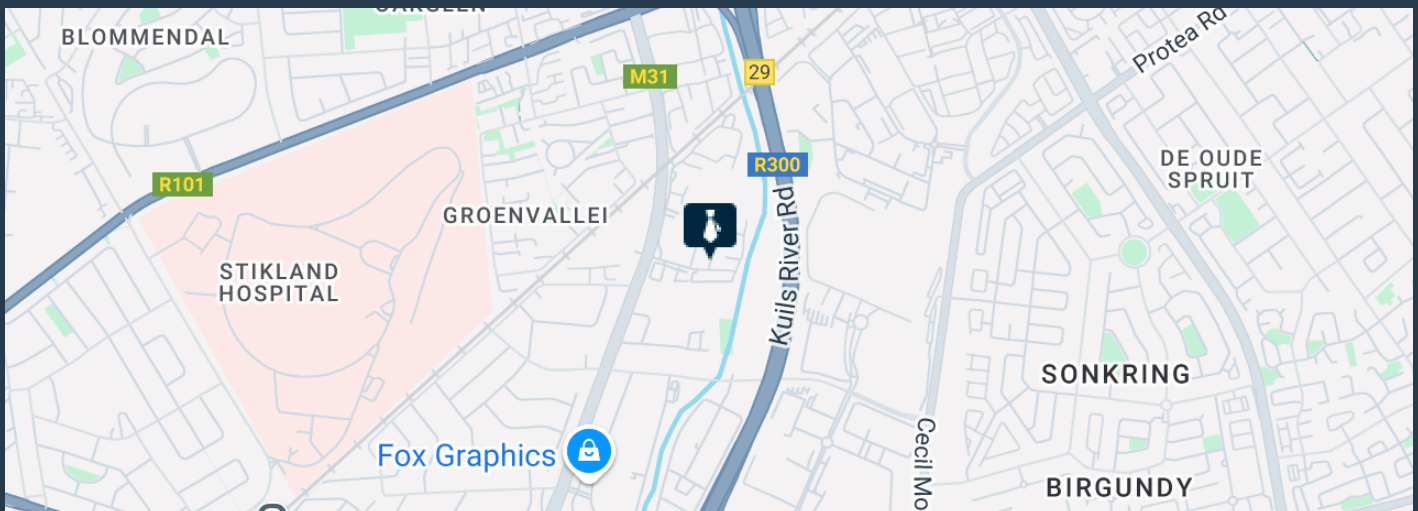

PROPERTY DETAILS

▲ Floor Size	409m ²
▲ Zoning	Industrial

WEB REF: SCL2314

Jack Taggart | 0673061828 | jackt@spire.co.za

PROPERTY | WITH PURPOSE

R44,990 per month excl. VAT
R110 per m²



www.spire.co.za

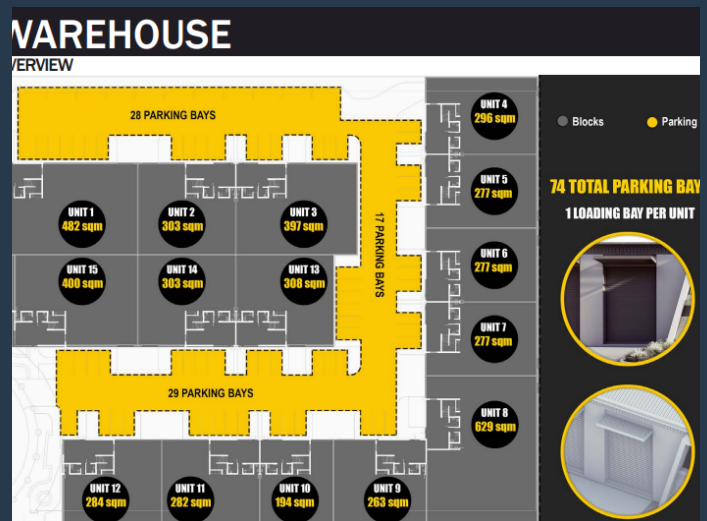
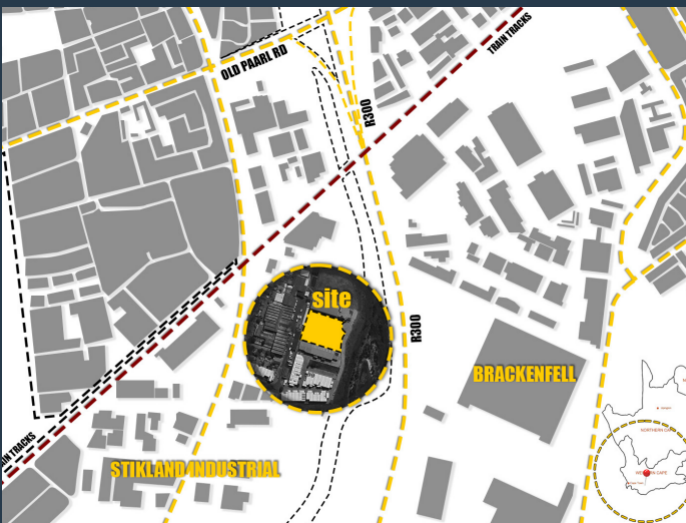

CONTACT US



Jack Taggart
Agent

📞 (021) 6854020
📱 0673061828
✉ jackt@spire.co.za



Kevin Hellyer
Candidate Property Practitioner

📞 (021) 6854020
📱 061 484 5578
✉ kevinh@spire.co.za

WEB REF: SCL2314

Jack Taggart | 0673061828 | jackt@spire.co.za