

PROPERTY | WITH PURPOSE

R63,948 per month excl. VAT

R115 per m²



www.spire.co.za

TO LET



GRAYSTON OFFICE PARK

128 Peter Road

344m² Office Space to let in Sandton Central - Grayston Office Park. Grayston Office Park is a well-established, low-rise office development comprising free-standing buildings nestled within beautifully landscaped gardens. Perfectly positioned near Sandton CBD, the park offers excellent access to the M1 highway via Grayston Drive, ensuring seamless connectivity for both staff and clients. On-site conveniences include a charming coffee shop, with Grayston Shopping Centre just a short walk away, adding to the overall appeal and ease of working at this location. A premium 556m² office unit is currently available to let at R115/m² (excl. VAT & utilities). This modern, open-plan space features standard office lighting and air conditioning,...

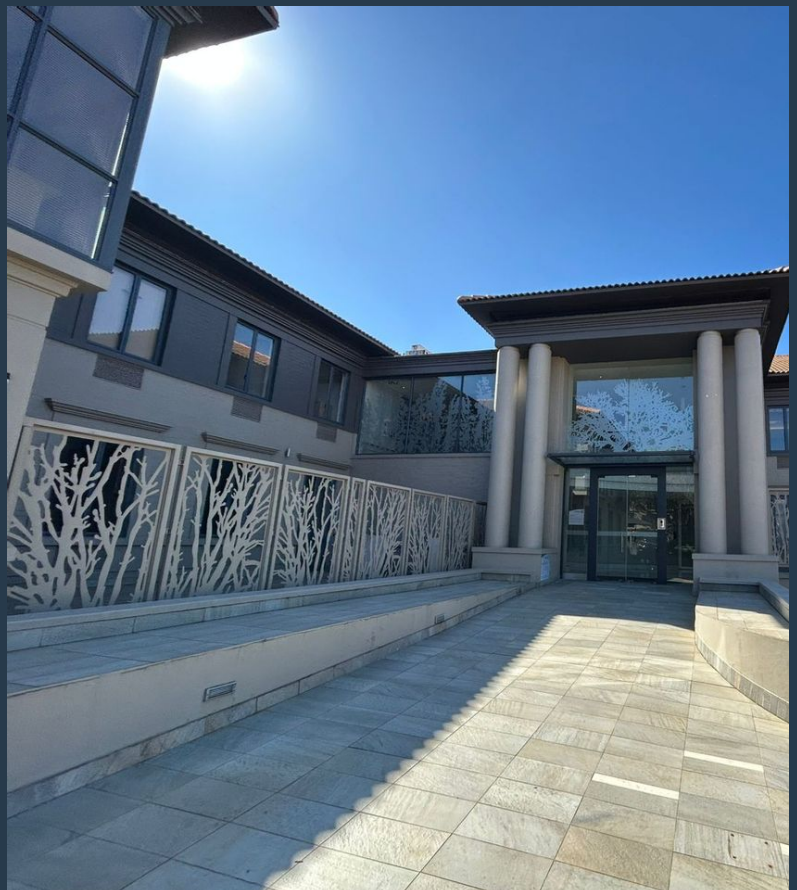

WEB REF: SCL2435

Brandon Munyanyi | 0746705886 | brandonm@spire.co.za

PROPERTY | WITH PURPOSE

R63,948 per month excl. VAT

R115 per m²



www.spire.co.za

556M2 OFFICE SPACE TO LET IN SANDTON CENTRAL - GRAYSTON OFFICE PARK

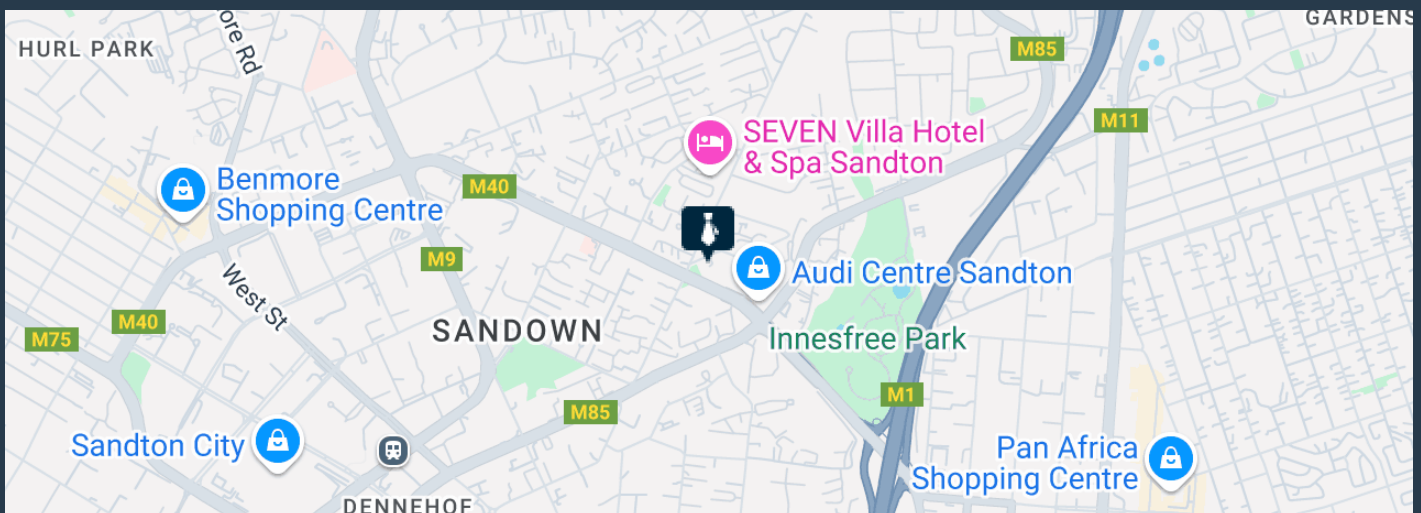

PROPERTY DETAILS

▲ Security	Yes	▲ Floor Size	556m ²
▲ Air Conditioning	Yes	▲ Land Size	800
		▲ Zoning	Commercial

WEB REF: SCL2435

Brandon Munyanyi | 0746705886 | brandonm@spire.co.za

PROPERTY | WITH PURPOSE

R63,948 per month excl. VAT

R115 per m²



www.spire.co.za



CONTACT US



Brandon Munyanyi

Agent

(011) 2685871

0746705886

brandonm@spire.co.za

WEB REF: SCL2435

Brandon Munyanyi | 0746705886 | brandonm@spire.co.za