

PROPERTY | WITH PURPOSE

**R81,360** per month excl. VAT

R80 per m<sup>2</sup>



[www.spire.co.za](http://www.spire.co.za)

**TO LET**



1017 Sqm Office Space to Let in Parktown within 24 Wellington. . This space is white-boxed and features two kitchenettes, three strong rooms, internal bathrooms and ample storage space. The building has a back up generator and 24-hour security. 24 Wellington is situated in the heart of Parktown's historic business district. The area is in close proximity to Rosebank, Saxonwold, Westcliff and Johannesburg CBD, with access to the M1 and M27 highways. We have been helping businesses just like yours to find their perfect commercial retail or industrial space. Our team of property professionals are ready to find your perfect space. We have a longstanding relationship with the top property funds and property management companies in the city....



WEB REF: CL2579

Kate Shimwell | 082 493 0273 | [kates@spire.co.za](mailto:kates@spire.co.za)



PROPERTY | WITH PURPOSE

**R81,360** per month excl. VAT

R80 per m<sup>2</sup>



[www.spire.co.za](http://www.spire.co.za)

## OFFICE SPACE TO LET IN PARKTOWN, JOHANNESBURG | 24 WELLINGTON



### PROPERTY DETAILS

▲ Security	Yes	▲ Floor Size	1017m <sup>2</sup>
▲ Air Conditioning	Yes	▲ Zoning	Commercial

WEB REF: CL2579

Kate Shimwell | 082 493 0273 | [kates@spire.co.za](mailto:kates@spire.co.za)

PROPERTY | WITH PURPOSE

**R81,360** per month excl. VAT

R80 per m<sup>2</sup>



[www.spire.co.za](http://www.spire.co.za)

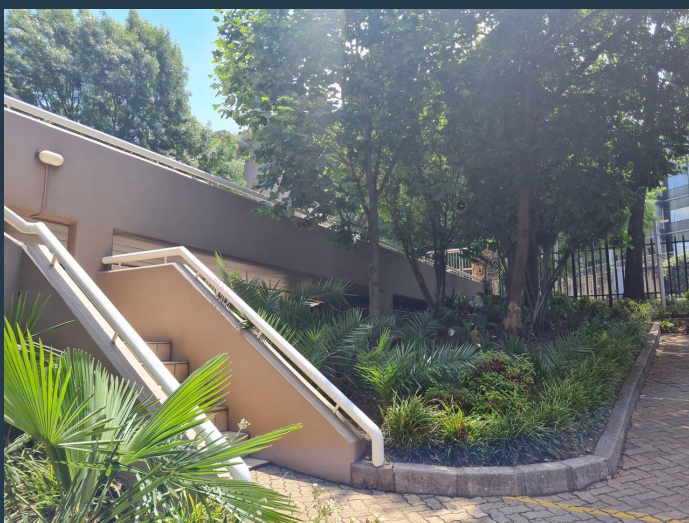
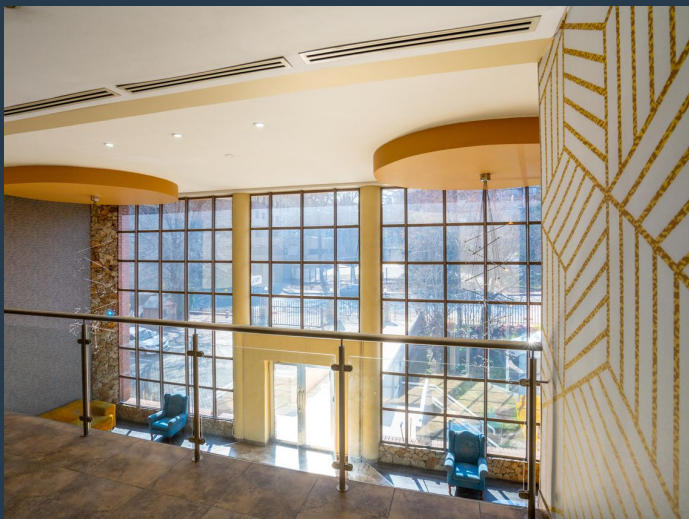

## CONTACT US



**Kate Shimwell**  
Agent

☎ (011) 2685871  
📱 082 493 0273  
✉ [kates@spire.co.za](mailto:kates@spire.co.za)



**Kate Shimwell**  
Agent

☎ (011) 2685871  
📱 082 493 0273  
✉ [kates@spire.co.za](mailto:kates@spire.co.za)

WEB REF: CL2579

Kate Shimwell | 082 493 0273 | [kates@spire.co.za](mailto:kates@spire.co.za)